

PREPARED FOR:
JAY IERONIMO
333 COUNTRY LN.
GLENVIEW IL, 60025

PLAT OF SURVEY

-OF-

THE EAST 1/2 OF LOT 4, AND ALL OF LOTS 56 AND 57, BLOCK C
OF CISCO BEACH, A SUBDIVISION, LOCATED IN SECTION 5,
TOWN 1 NORTH, RANGE 17 EAST, TOWN OF LINN,
WALWORTH COUNTY, WISCONSIN.

LOT 55

KROTT SURVEYING INC.

N3705 WILLOW BEND LANE
LAKE GENEVA WI. 53147
PHONE # (262)248-3697
FAX # (262)249-0639



LEGEND

- FOUND IRON PIPE
- FOUND IRON BAR
- FOUND CONCRETE MONUMENT
- × FOUND CUT CROSS IN CONCRETE
- ⊕ CONCRETE LID
- ⊙ WELL
- ⊗ UTILITY POLE
- OVERHEAD WIRES
- (xx) RECORDED AS
- TAX ID # ICI 00032 & 71
- JOB # 10-013

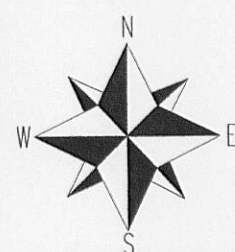

0 10 20 30 40 50
SCALE 1"=10'

I have surveyed the above-described property and the above map is a true representation thereof and shows the size and location of the property, its exterior boundaries, the location and dimensions of all structures thereon, fences apparent easements and roadways and visible encroachments, if any.

This survey is made for the exclusive use of the present owners of the property, and also those who purchase, mortgage, or insure the title thereto within one (1) year from date hereof; and as to them I warrant the accuracy of said survey map.

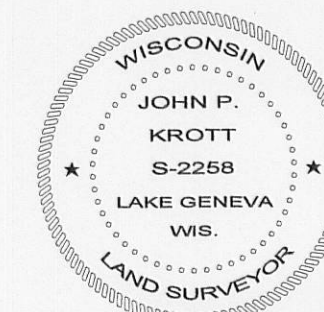
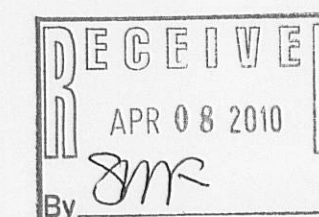

DATED THIS 27th, DAY OF JANUARY 2010

John P. Krott
JOHN KROTT S - 2258
Wisconsin Registered Land Surveyor
(original if signed in red)

117-3157